



MC.202 Folgore

eduard

49 288

1/48 scale detail set for Hasegawa kit • sada detailů pro model 1/48 Hasegawa

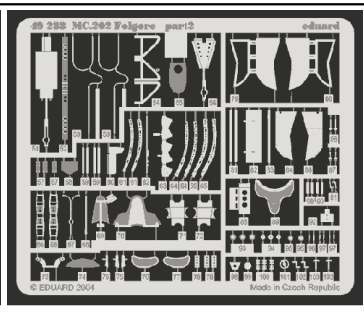
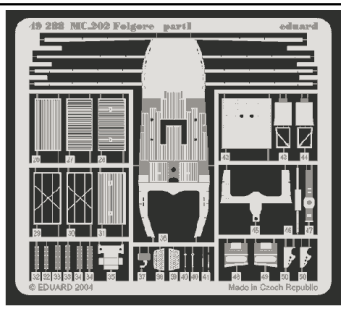
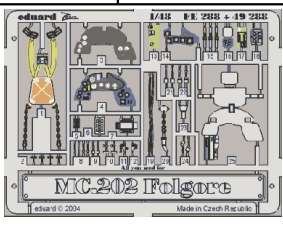

- APPLY EXPRESS MASK AND PAINT BEFORE GLUING
POUŽÍT EXPRESS MASK NABARVIT PŘED SLEPENÍM
- SYMMETRICAL ASSEMBLY
SYMETRICKÁ MONTÁŽ
- REMOVE
ODSTRANIT
- GRIND
OBROUSIT
- DRILL HOLE
VRTAT OTVOR
- BEND
OHNOUT
- OPTION
VOLBA
- REPLACE
NAHRADIT

FILM

ORIGINAL KIT PARTS
PŮVODNÍ DÍLY STAVEBNICE
 PHOTO-ETCHED PARTS
LEPTANÉ DÍLY
 PARTS TO BE REMOVED
DÍLY K ODSTRANĚNÍ
 FILL
TMELIT

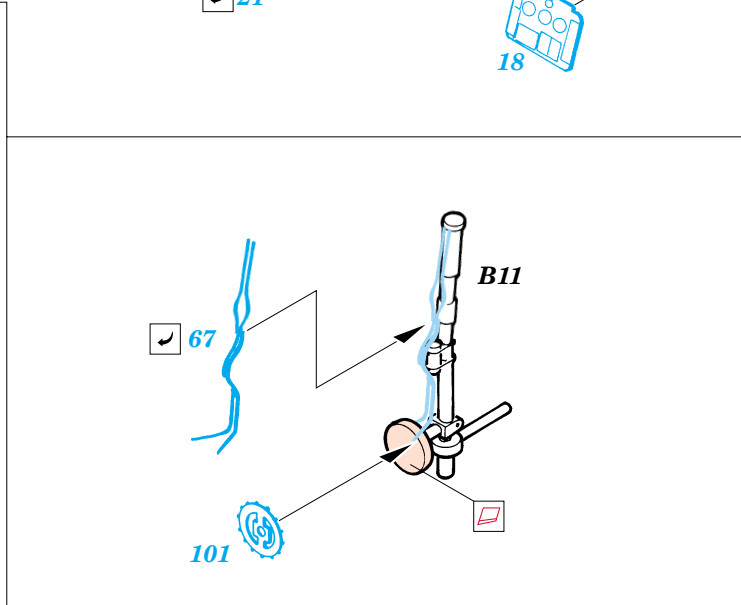
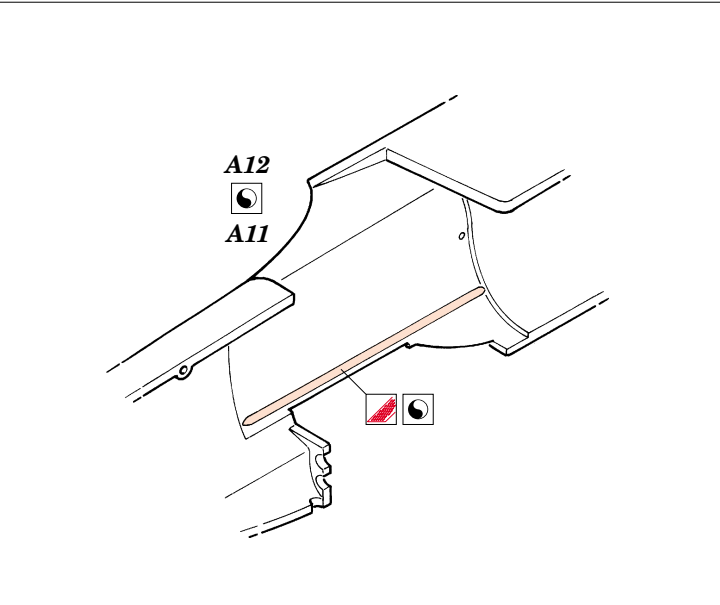
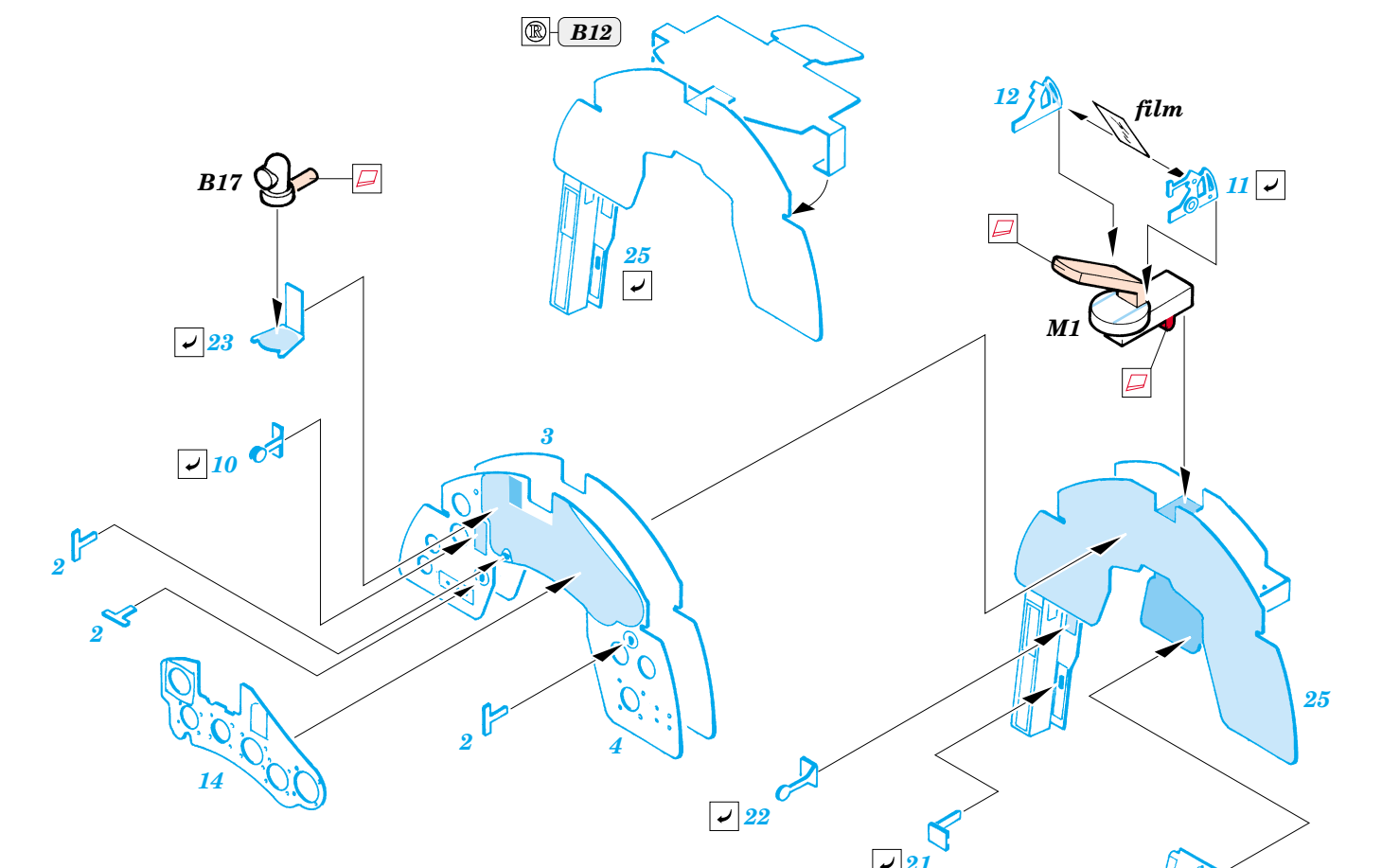

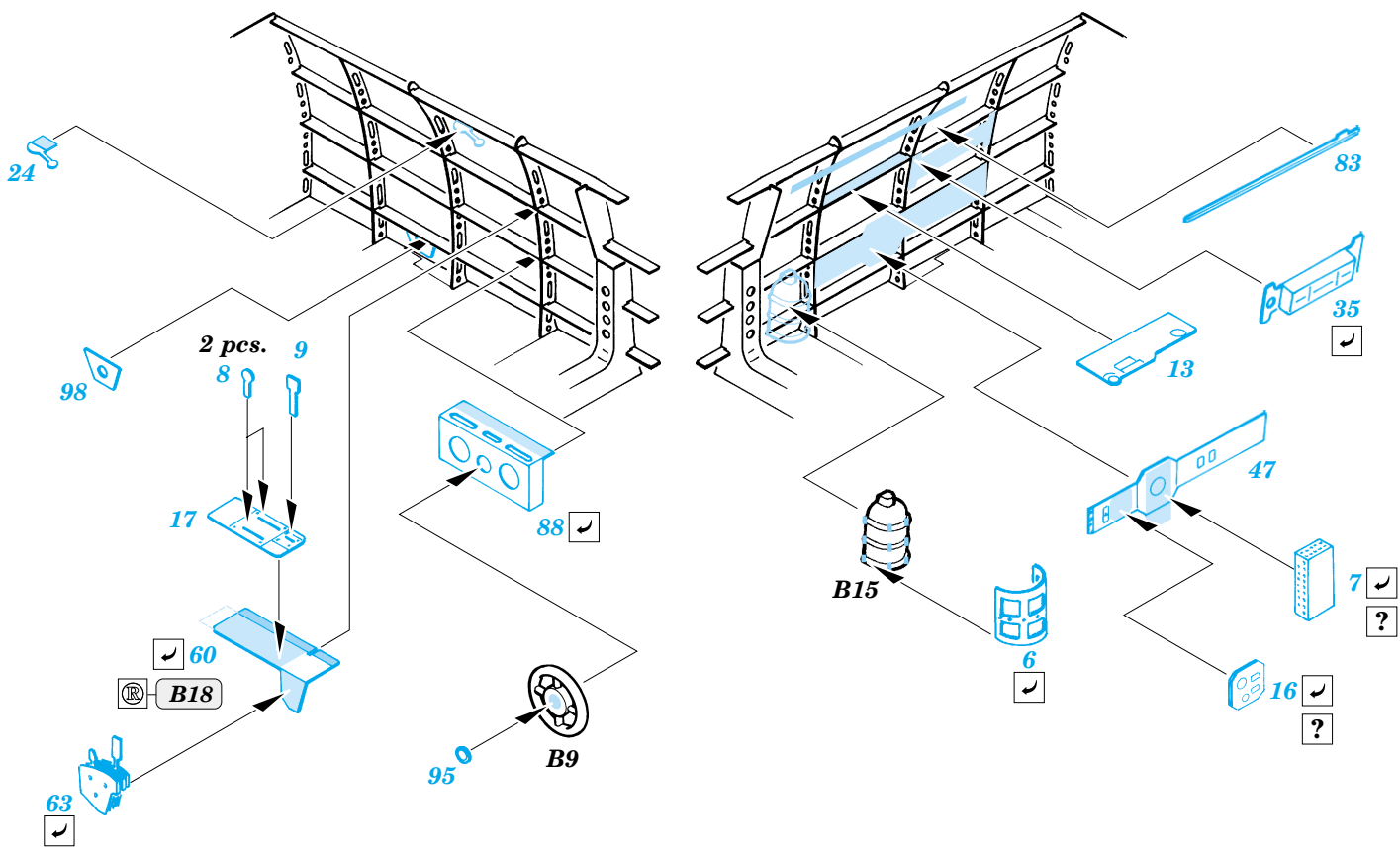
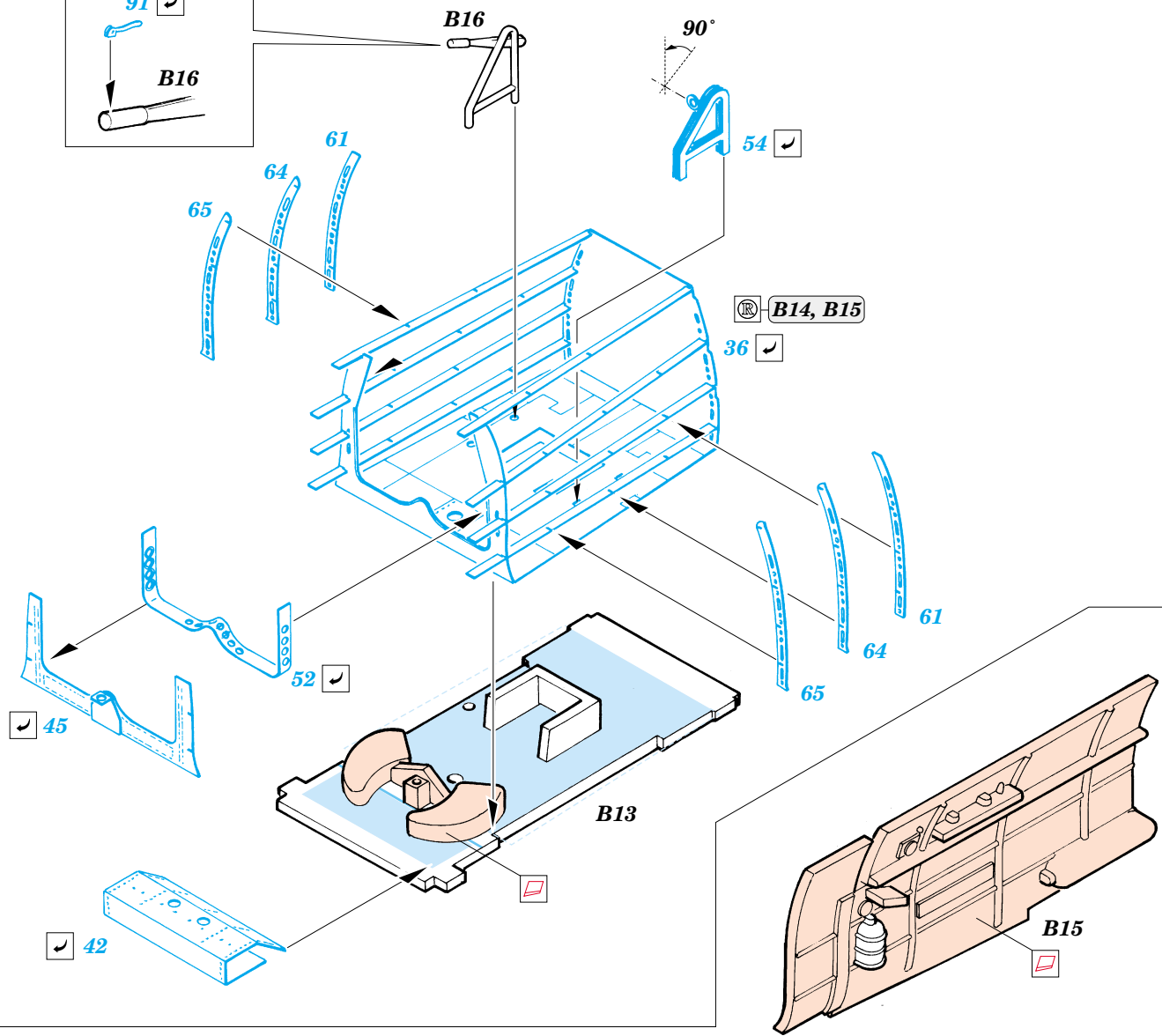
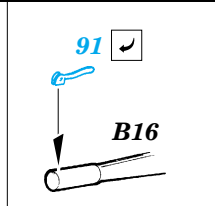

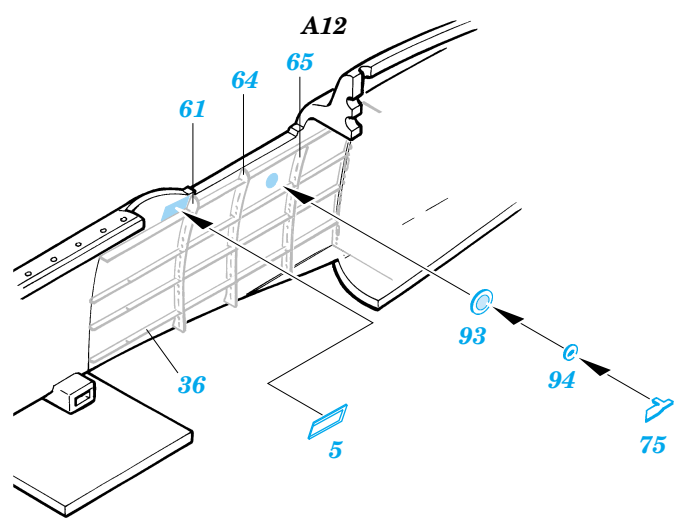
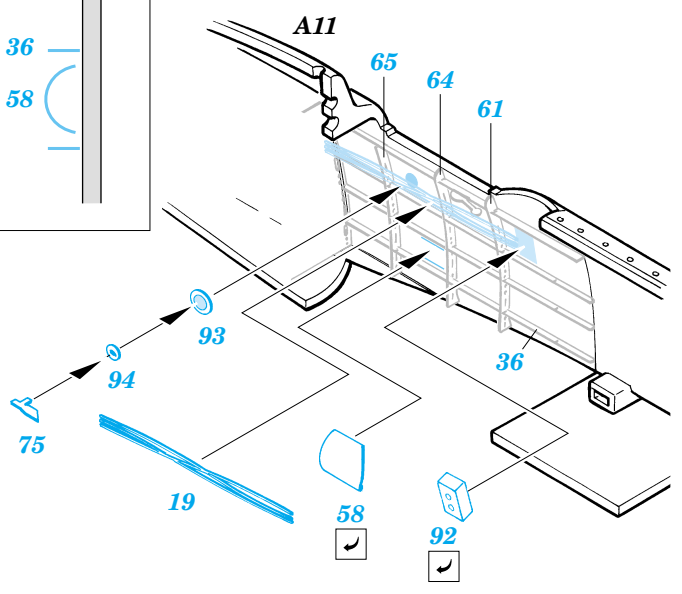
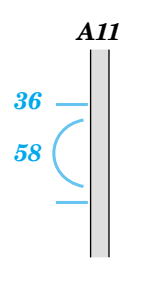
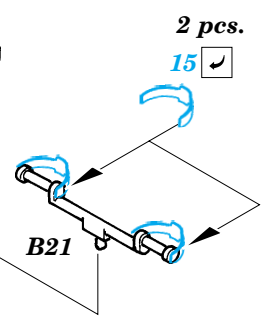
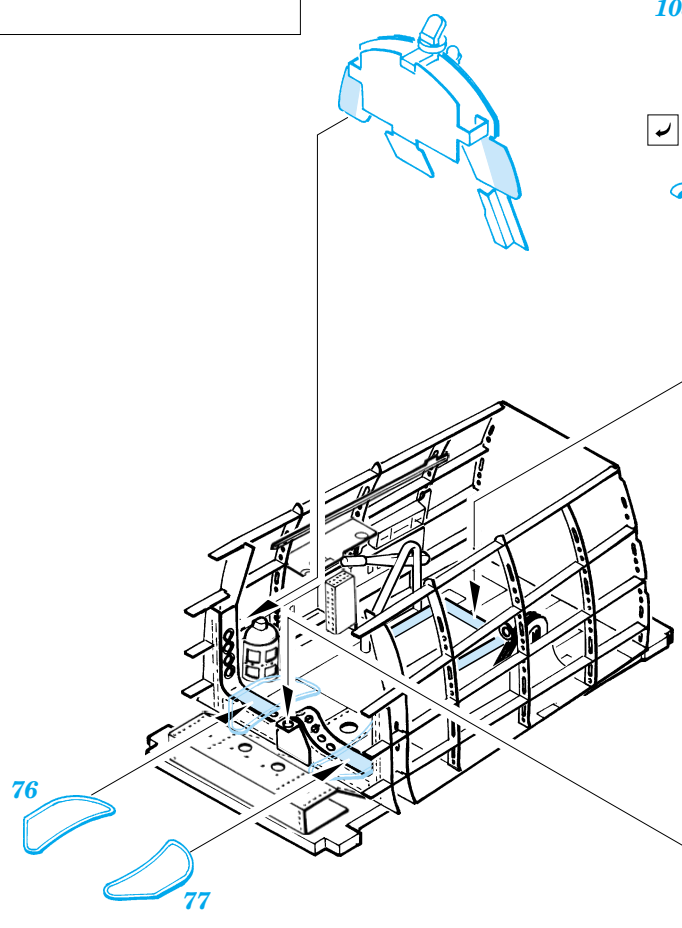
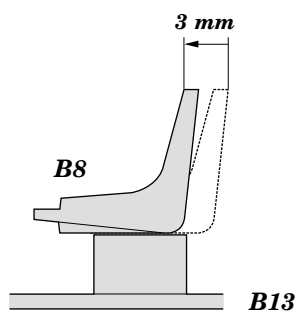
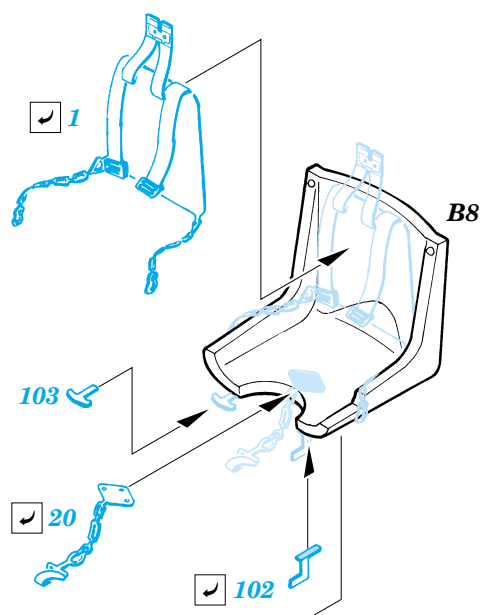
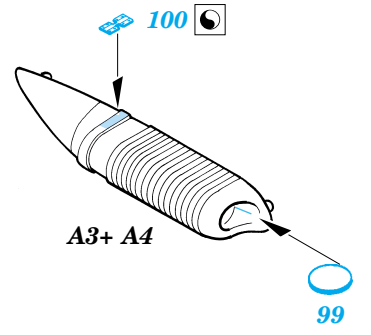

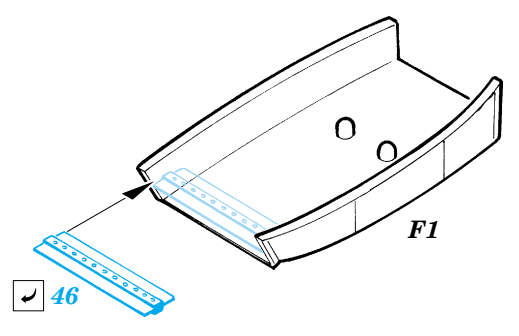
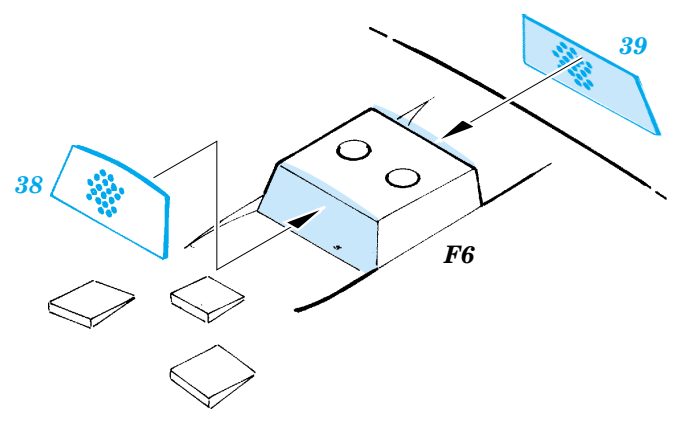
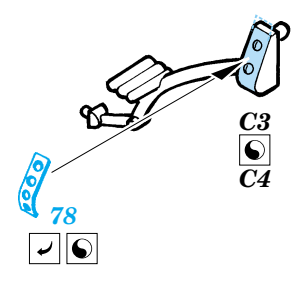
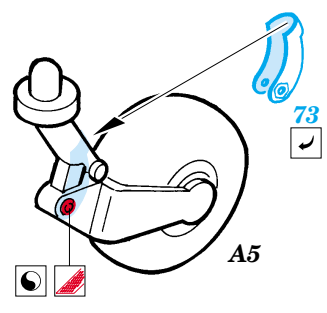
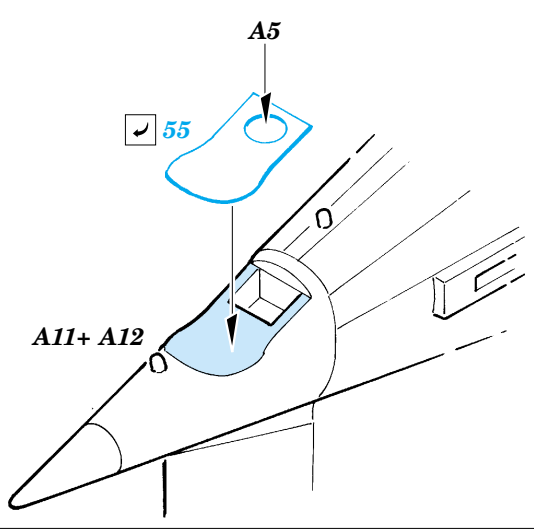
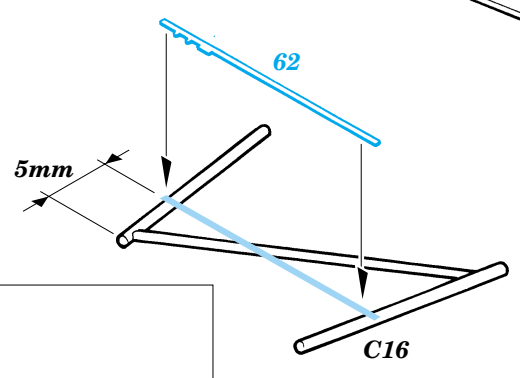
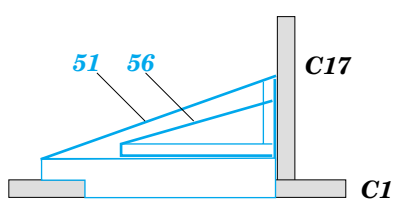
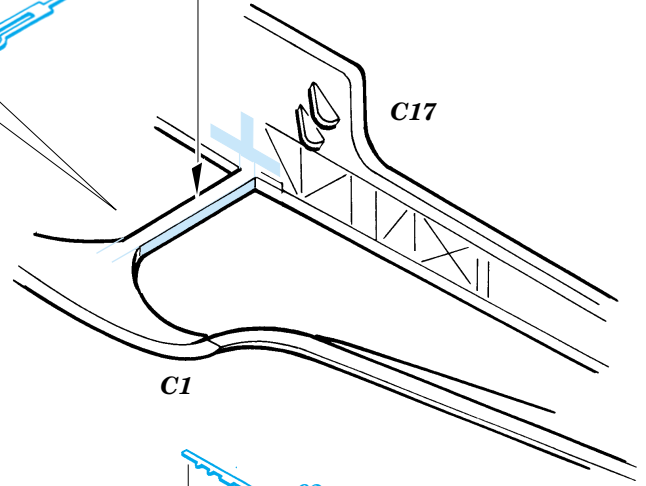
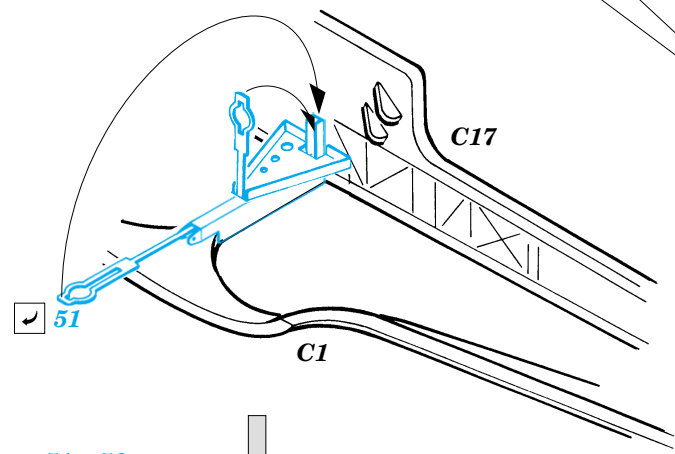
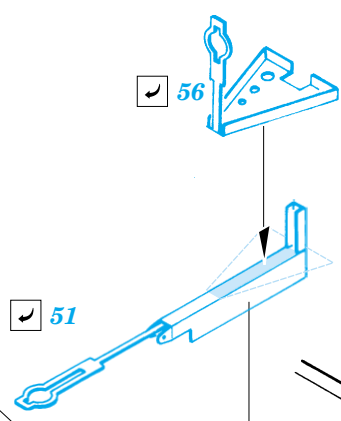
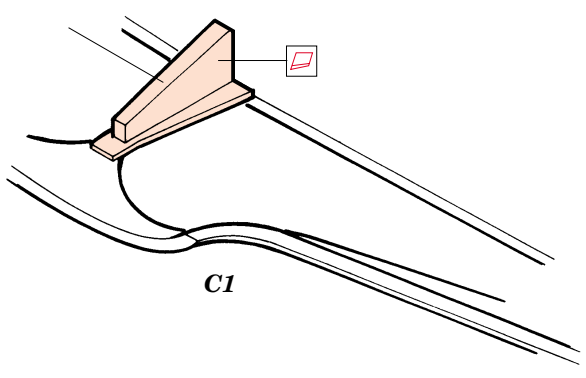

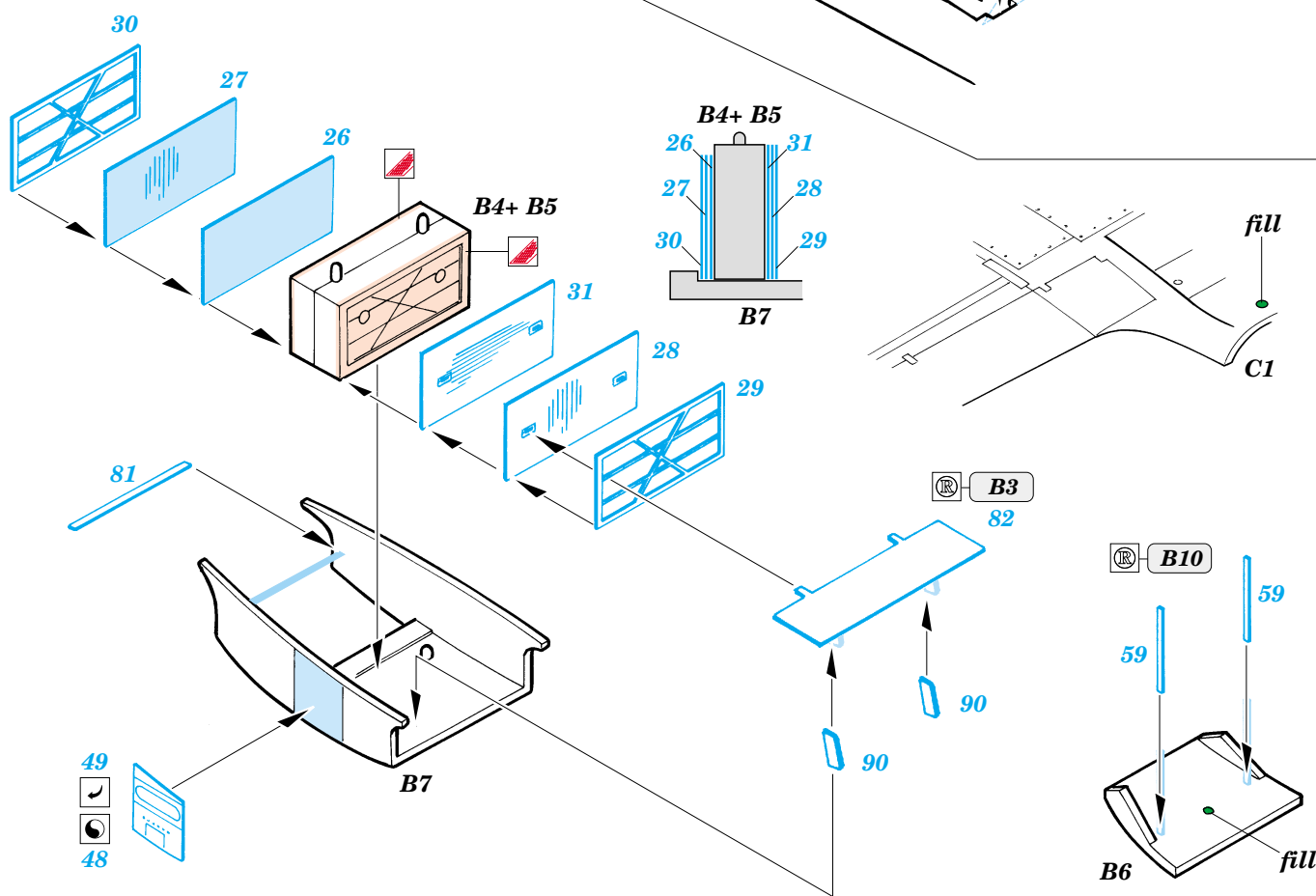
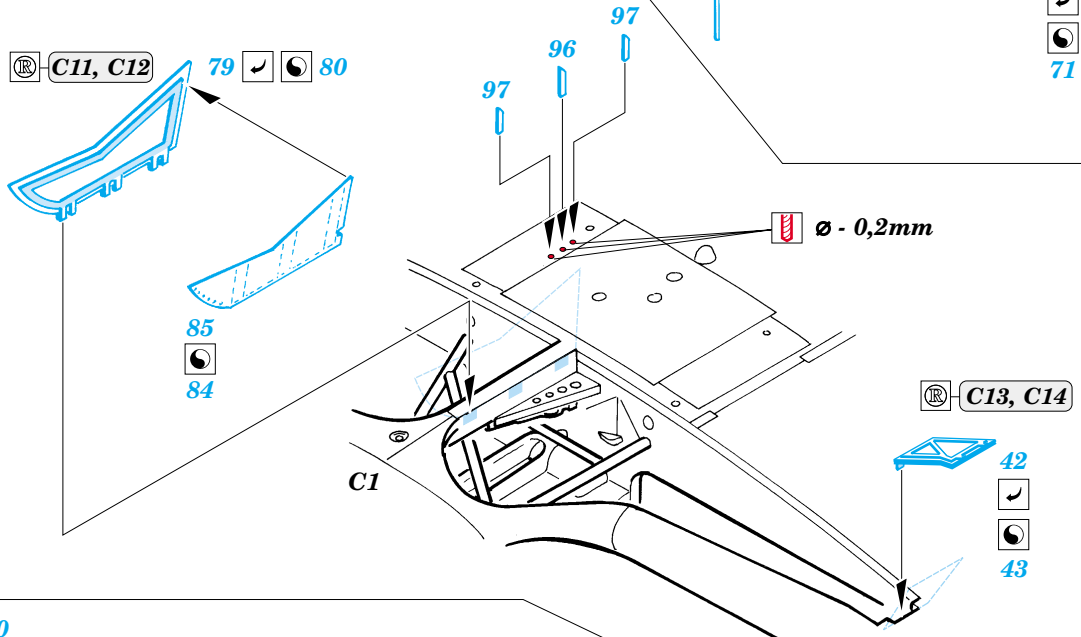
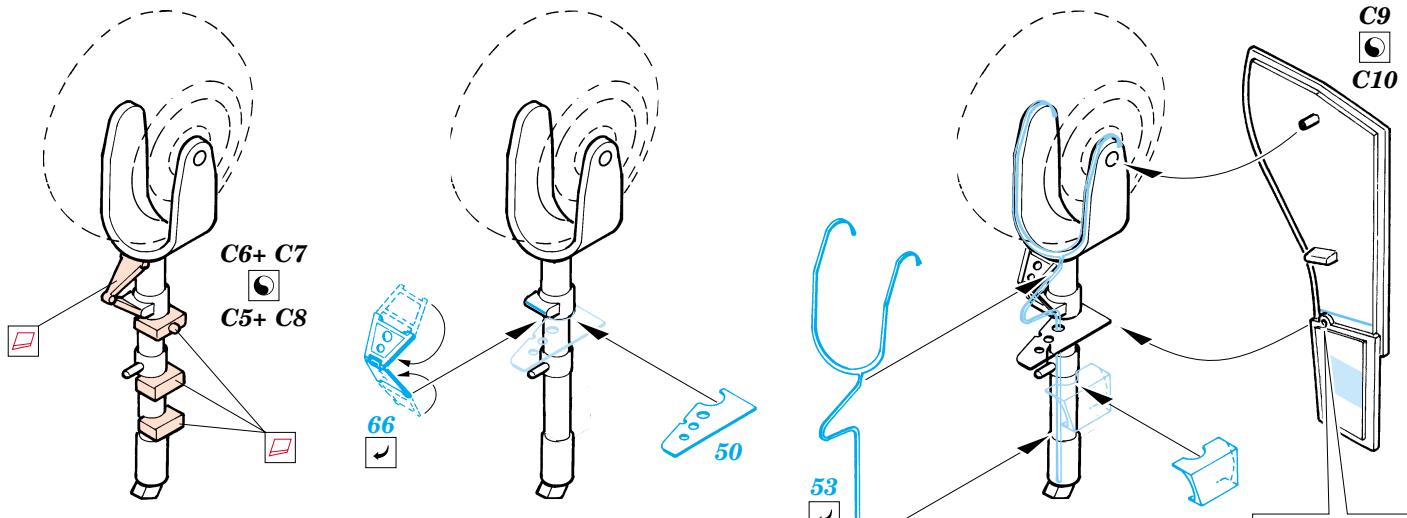

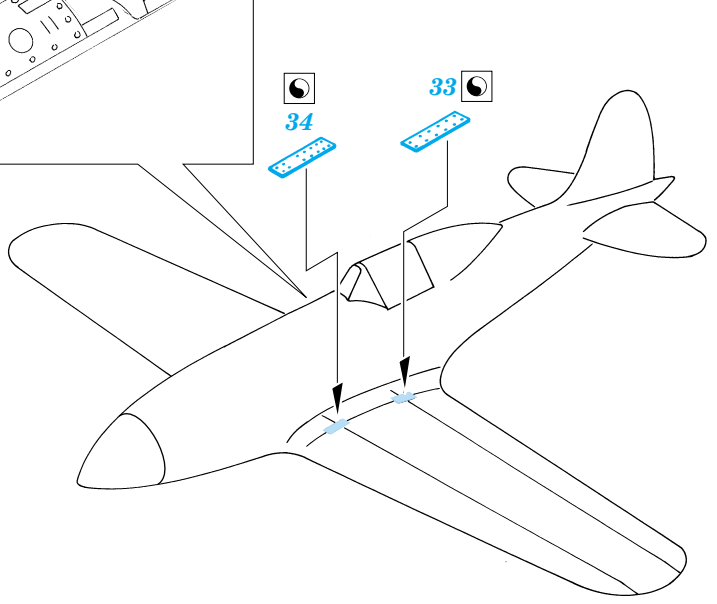
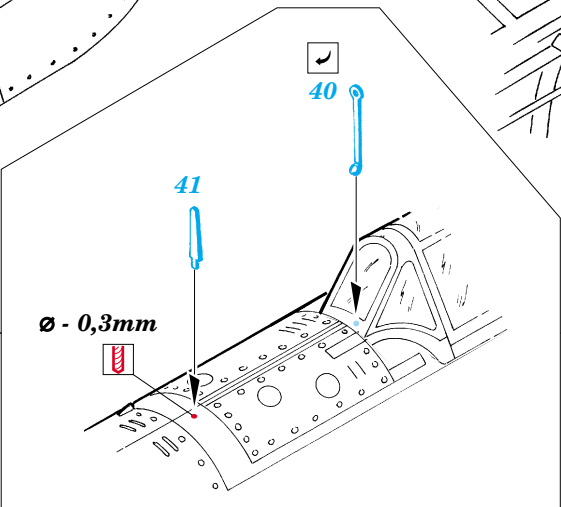
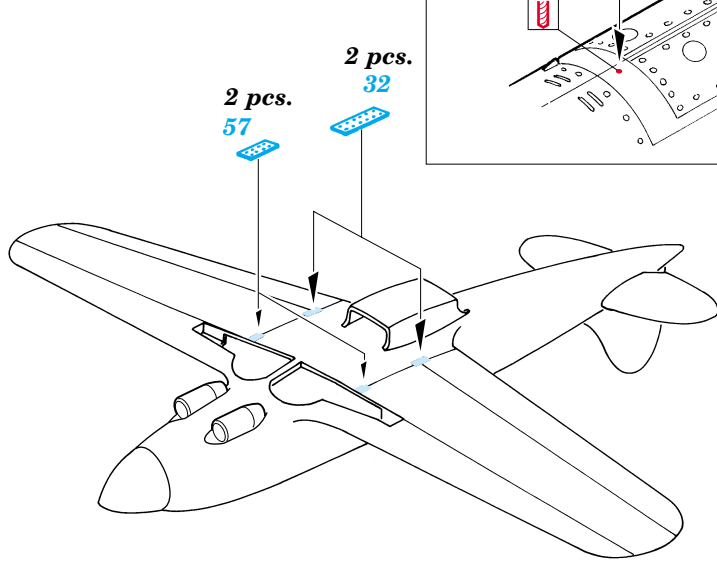
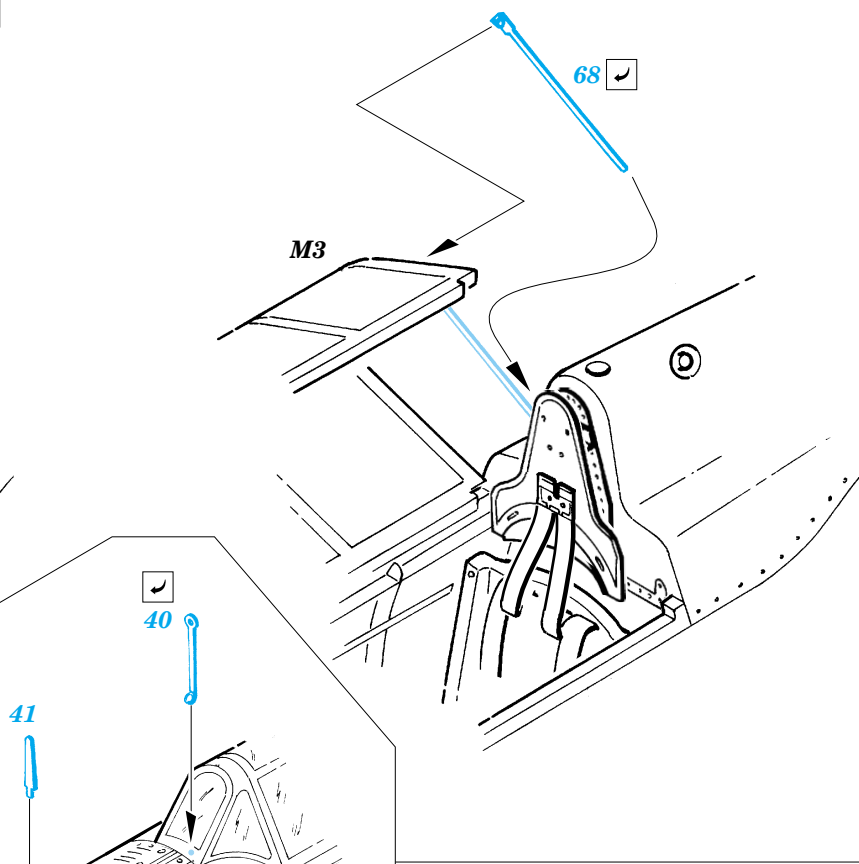
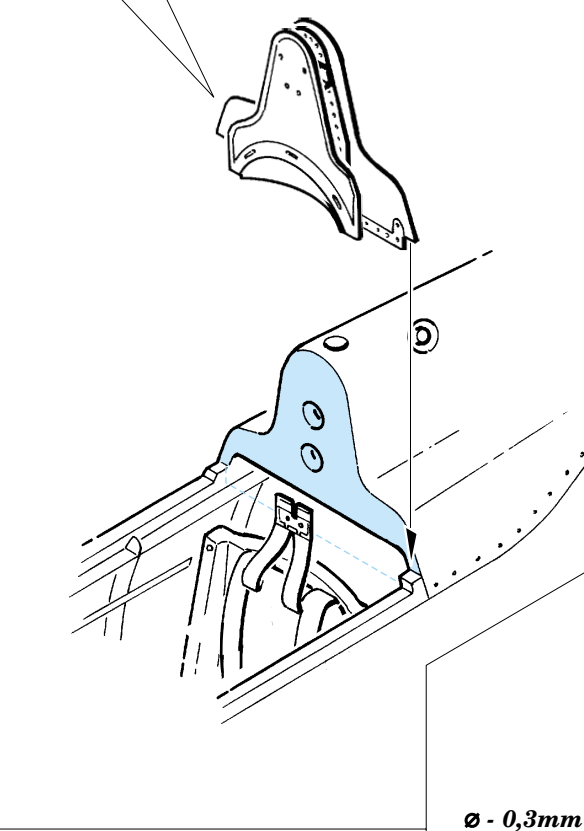
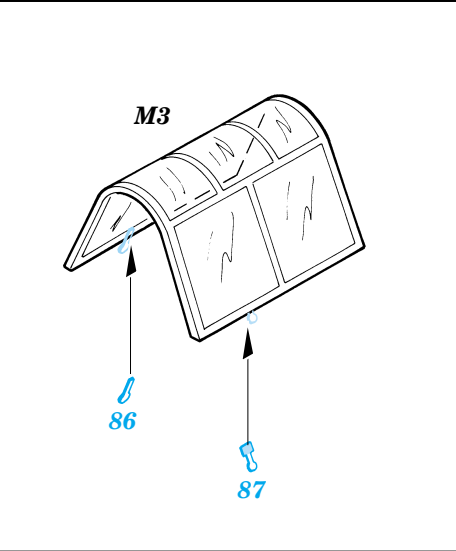
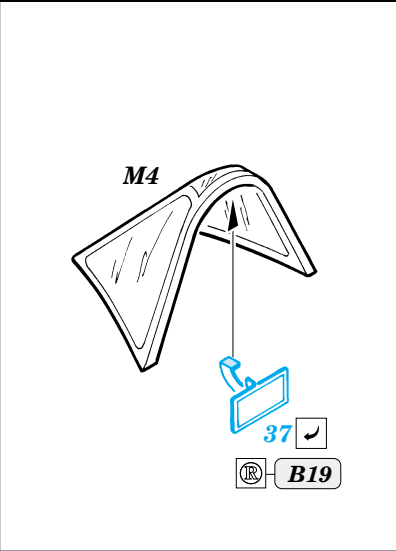
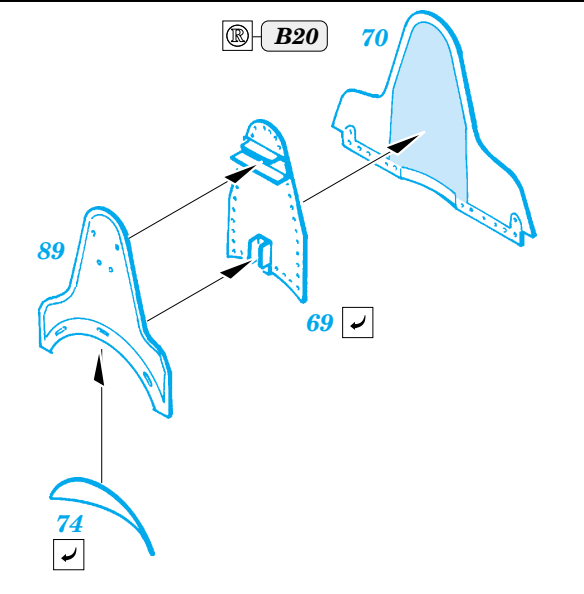

REFERENCES:
 Aero Detail 15 - Macchi C.200 / 202 / 205
 Replic # 101 / janvier 2000